

For technical support please contact : pm@promaster-electronic.com

(1) First remove 3 screws from the steering wheel (left, right, bottom)

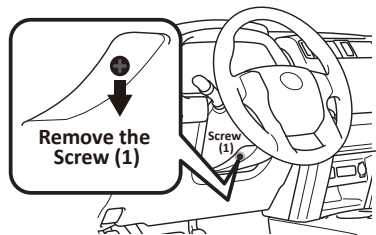

Remove screw (1) under the steering wheel



Turn on the ignition to unlock the steering wheel

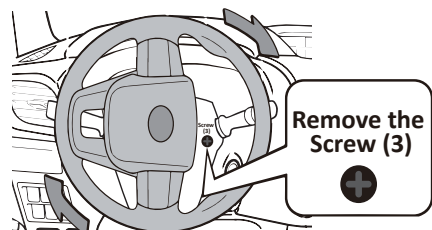

Turn the steering wheel right to remove the right screw (3)

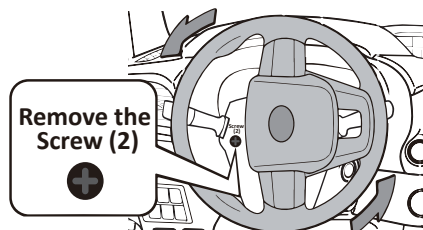

Turn the steering wheel left to remove the left screw (2)

(2) a. Turn the steering wheel to center position and turn off the power.

b. Remove the steering column cover.

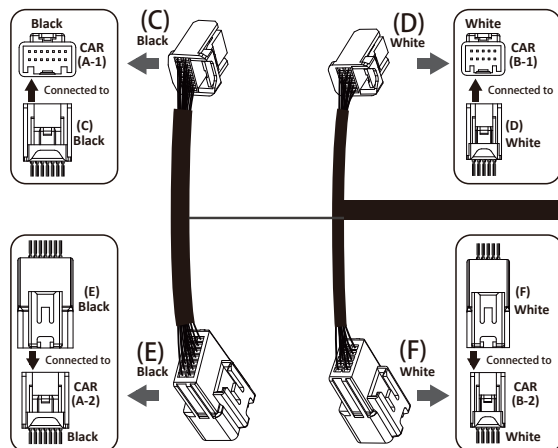

Sensor will be activated
3.5 minutes after
door locked by remote

! WARNING:
CHOKING HAZARD -- Small
parts included, not for
children under 3 years old.

After installation, press Lock button on remote and
wait for **9** minutes (Information collected by sensor)

(3)

Please ensure the headlights
are setup to "AUTO" .

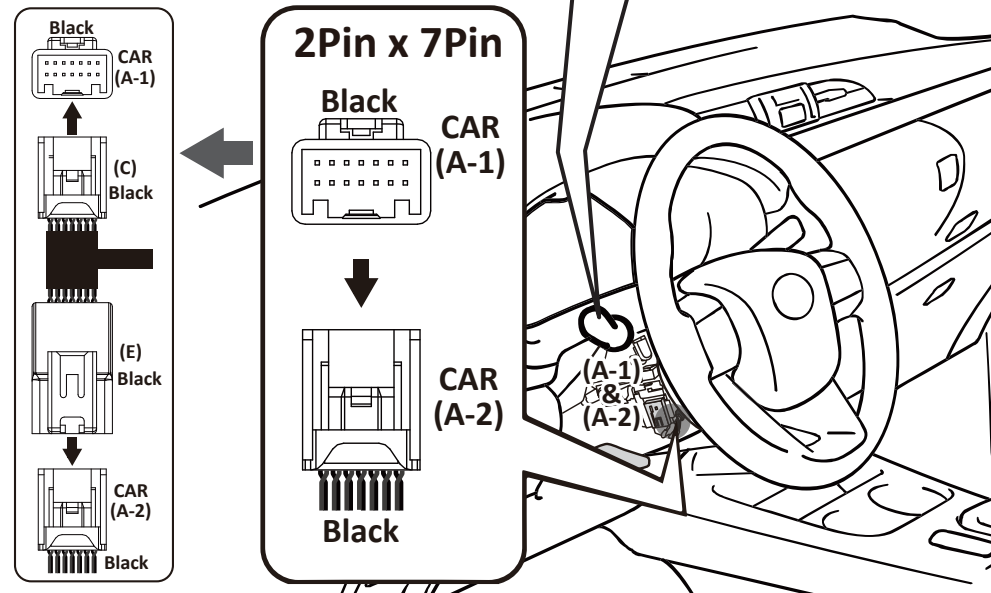
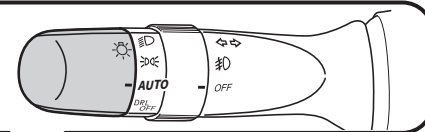

(4)

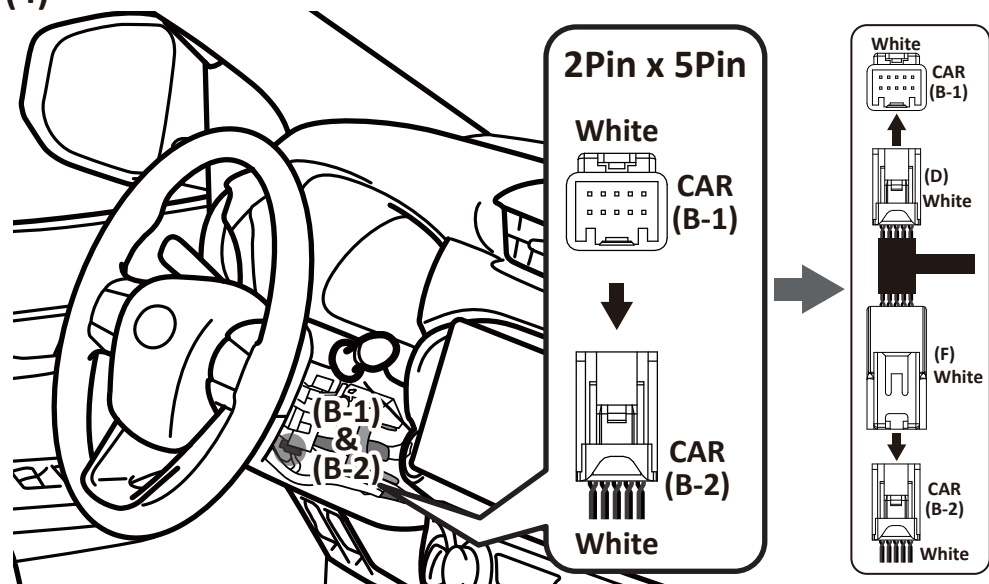

For technical support please contact : pm@promaster-electronic.com

(1) First remove 3 screws from the steering wheel (left, right, bottom)

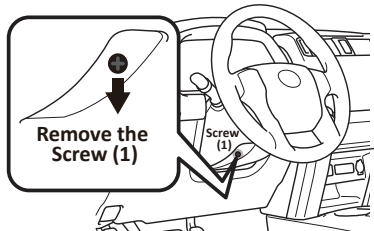

Remove screw (1) under the steering wheel



Turn on the ignition to unlock the steering wheel

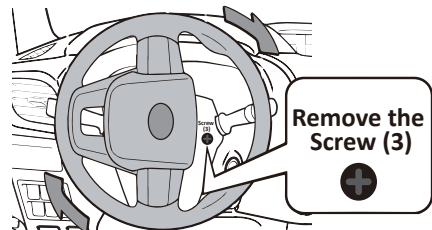

Turn the steering wheel right to remove the right screw (3)

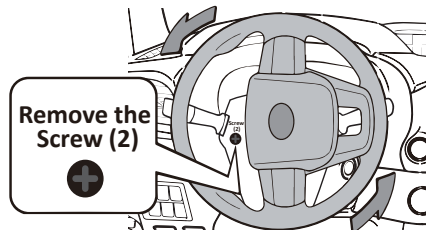

Turn the steering wheel left to remove the left screw (2)

**(2) a. Turn the steering wheel to center position and turn off the power.
b. Remove the steering column cover.**

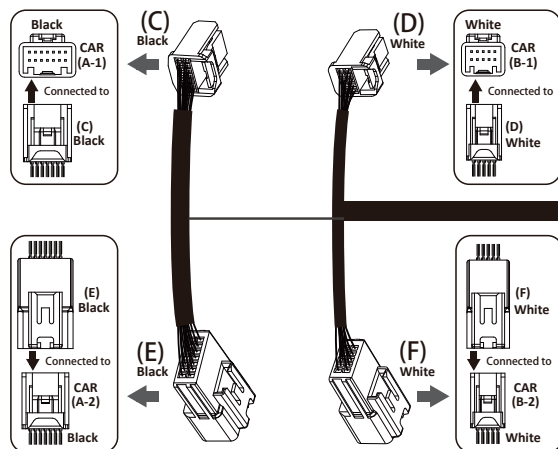

Sensor will be activated
3.5 minutes after
door locked by remote

! WARNING:
CHOKING HAZARD -- Small
parts included, not for
children under 3 years old.

After installation, press Lock button on remote and
wait for **9** minutes (Information collected by sensor)

(3)

Please ensure the headlights
are setup to "AUTO" .

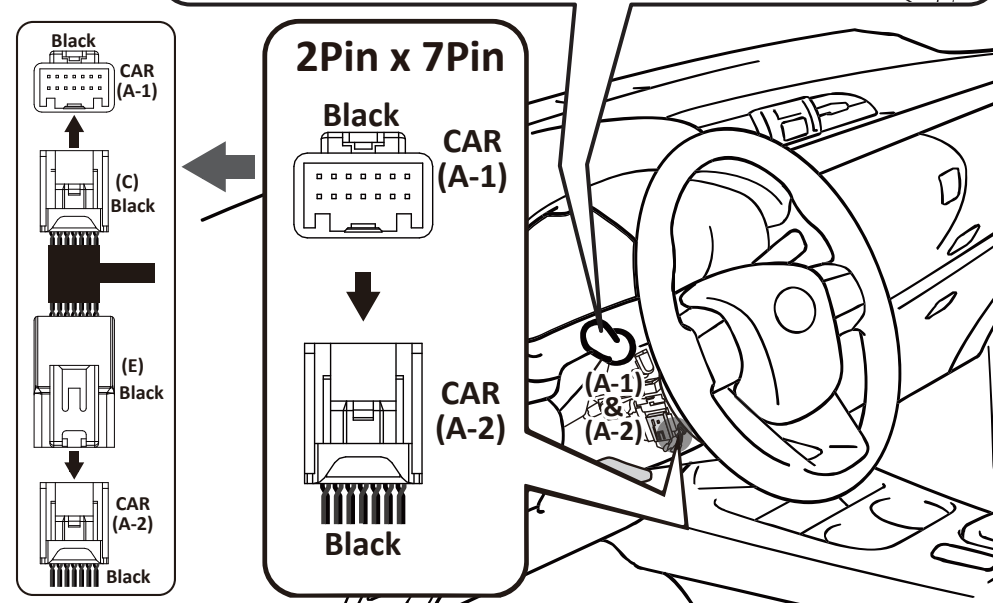
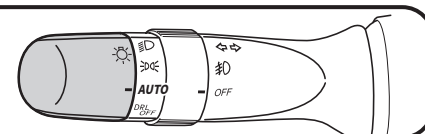

(4)

